

Modular Drainage System

Product Overview



The Rosehill Modular Drainage System is manufactured using recycled tyre rubber, bonded with a unique polyurethane binder, and supports sustainable infrastructure development. It integrates efficiently into both existing and new rail networks, ensuring effective water management and contributing to a resilient, Net Zero future.

- **Unique Drainage Properties:** Unlike traditional pipes, Rosehill's Modular Drainage System permits the free flow of excess water, silts, and hydraulic pressures into railway drainage networks, ensuring continuous and passive water control.
- **Technological Innovation:** Utilising a patent-pending process and materials, the Modular Drainage System introduces a new standard in drainage technology with its low-energy cold-cure manufacturing processes, producing low-carbon, high-quality recycled products.

The Modular Drainage System is adaptable for use in various rail drainage scenarios, including:

- **Track and Trackside Drainage:** Improves drainage efficiency in areas at risk of waterlogging, maintaining appropriate water table levels and preventing standing water.
- **Land Boundaries and Earthworks:** Well-suited for tunnels, bridge abutments, and confined spaces, where robust drainage is essential.
- **Rail Assets and Structures:** Facilitates upgrades and repairs, improving catchpit functionality and interactions with trackside drainage structures.

Rosehill's Modular Drainage System significantly lowers the carbon footprint of construction projects by using materials that are both recycled and recyclable, meeting strict environmental standards and supporting efforts to achieve Net Zero emissions in infrastructure.

GET IN TOUCH



+44 (0)1422 839 610



info@rosehillrail.com



Beech Road, Sowerby Bridge,
West Yorkshire, HX6 2JT, UK

Modular Drainage System

Product Overview



Volume: 51.7 Liters
Approximate Weight: 33.6kg

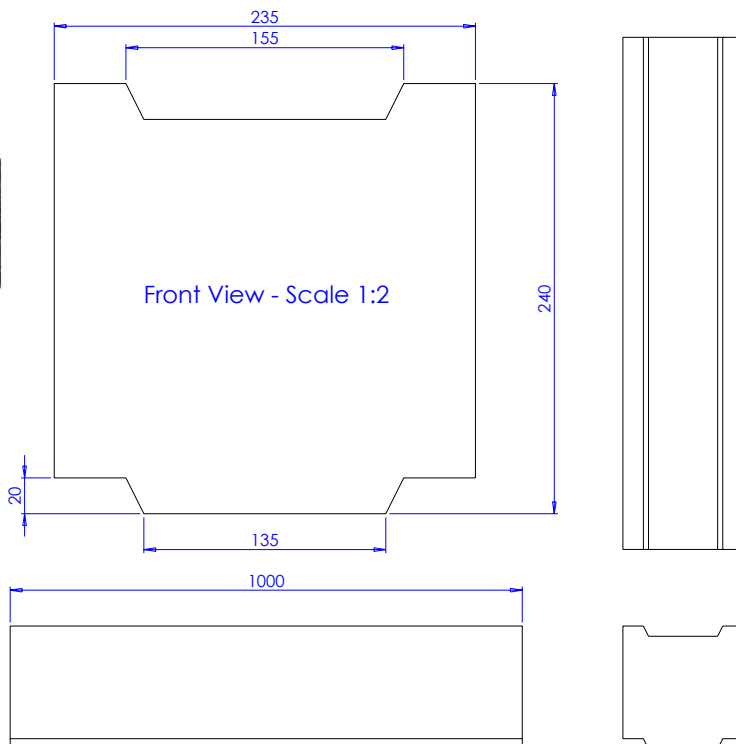

Volume: 33.4 Liters
Weight: 37.7kg

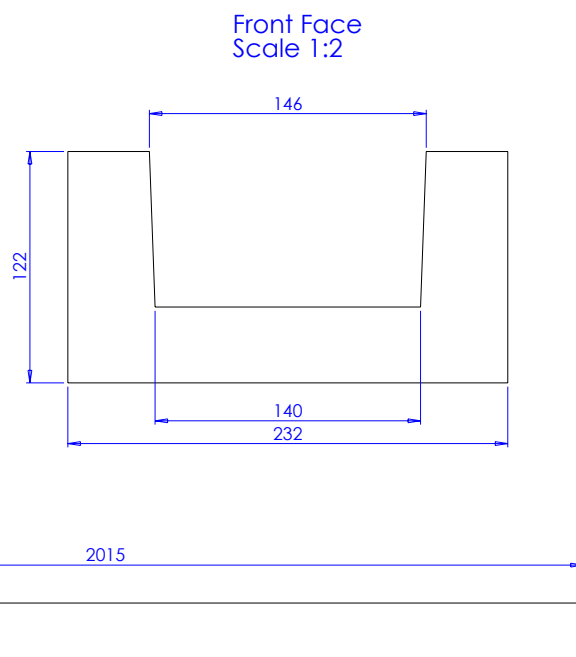

+44 (0)1422 839 610



info@rosehillrail.com



Beech Road, Sowerby Bridge,
West Yorkshire, HX6 2JT, UK