

Modular Drainage System

Hydraulic Performance & Capacity



	Rubber Drainage Units Capacity Litres m ³ m ⁻¹	Rubber Drainage Units Capacity Litres m ³ m ^{-0.75}	Weight Kg	Length mm	External Width mm	External Height mm Full & Half	External Height mm All Halfs	Internal Width Short / Diameter mm	Internal Width Long / Diameter mm	Internal Height / Diameter mm
Rubber Drainage Trough	11.3	8.5	18.85	1000	232	122	122	140	146	79
Rubber Drainage Stacker Full 45% Void	23.3	17.4	35.00	1000	235	220	/	235	/	220
Rubber Drainage Stacker Half 45% Void	11.1	8.3	17.5	1000	235	105	105	235	/	105
Trough and Stacker (x1)	34.6	25.9	53.85	1000	235	342	332	/	/	/
Trough and Stacker (x1.5)	45.7	34.2	71.35	1000	235	447	437	/	/	/
Trough and Stacker (x2)	57.8	43.4	88.85	1000	235	562	542	/	/	/
Trough and Stacker (x2.5)	68.9	51.7	106.35	1000	235	667	647	/	/	/
Trough and Stacker (x3)	81.1	60.8	123.85	1000	235	782	752	/	/	/
Trough and Stacker (x3.5)	92.2	69.1	141.35	1000	235	887	857	/	/	/
Trough and Stacker (x4)	104.4	78.3	158.85	1000	235	1002	962	/	/	/

Stacker

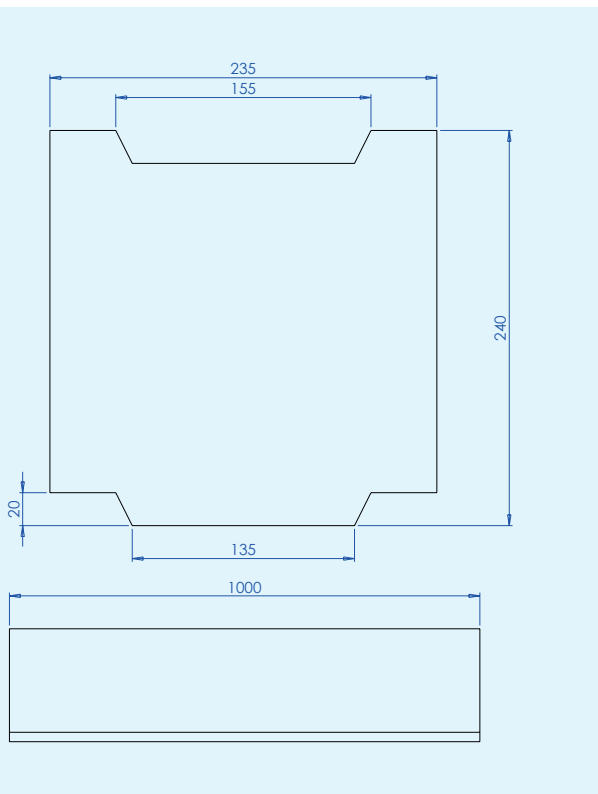

Trough

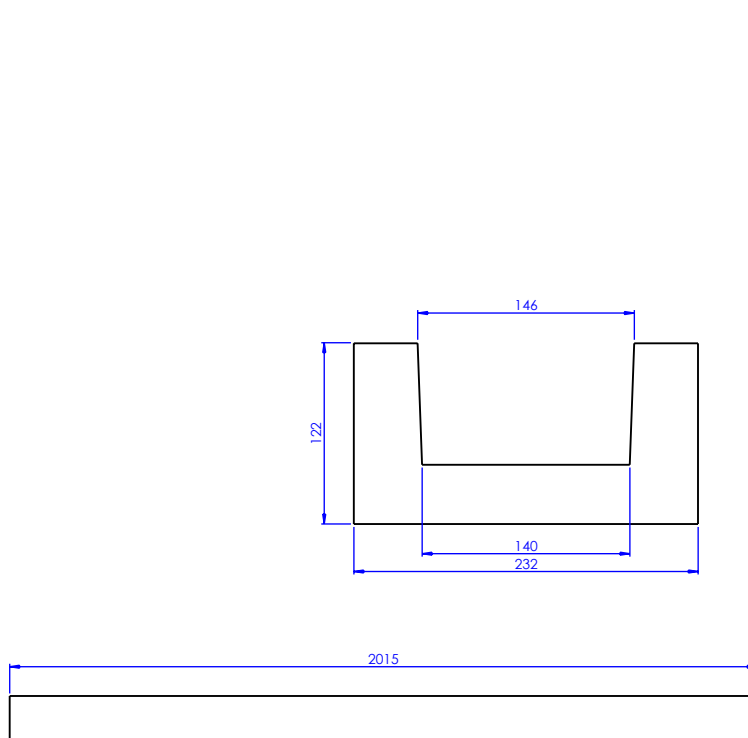

Get in touch:



+44 (0)1422 839456



info@rosehillhighways.com



rosehillhighways.com



Rosehill Polymers, Spring Bank Mills, Watson Mill Lane, Sowerby Bridge, West Yorkshire, HX6 3BW, UK